

Nixa Bands



Craig Finger, Director
Pat Jacobs, Asst. Dir.
Kim Martin, Asst. Dir.

HS Phone: 417.724.3550
HS Activity Line: 417.724.3551
HS Fax: 417.725.3716

205 North St (Mailing)
514 S. Nicholas (Shipping)
Nixa, MO 65714

JH Phone: 417.875.5473

Dear Winter Guard and Percussion Instructors:

We are looking forward to you and your students attending the Nixa Winter Guard and Percussion festival on March 12th. We think that once you arrive you will find that it is an excellent facility to house such an event. Our entire purpose is to provide the attending units with a relaxed, fun, and educational experience. If there is anything that we can do to make your day go smoother, please let us know.

DIRECTIONS TO NIXA HS...

- From Springfield: Go south on Campbell (HW 160), turn right (west) on Mt. Vernon (HW 14), turn left (south) on Nicholas (HW M), the HS will be on your left about a 1/2 a mile down.
- For those GPS folks, you can enter these coordinates into your device:
Latitude: 37.033 Longitude: 93.327
- Please note, Online mapping doesn't seem to be that accurate so I would use the above sources of information. Google Maps seems to do fine.

We are extremely proud of our facility and ask your help in reminding your members and crews that we would like to keep it in excellent condition. There should be absolutely no spinning, tossing or playing of any equipment in the school except in the equipment warm-up room and performance area. We also ask that the crews be careful moving props so walls and doors are not damaged. We reserve the right to refuse any equipment that may cause damage to our facility. **Percussion units:** Please take this into consideration when choosing carts to move equipment. Marching field carts should be avoided.

There will be concessions as well as some other fun souvenirs available. We hope that you encourage your students to browse through and support our band boosters. Obviously one the main reasons that we host a festival is to utilize the fundraising opportunities to help support the program. Our kids and parents will work hard to make the day pleasant for you so I hope you consider rewarding them by being patron of our concessions.

Again, we are looking forward to having you visit us at Nixa. If there is anything that we can do to make your day easier, please feel free to contact us.

Sincerely,

www.nixabands.org
craigfinger@nixaschools.net
patjacobs@nixaschools.net
kimmartin@nixaschools.net

Nixa Winter Guard and Percussion Festival
March 12, 2011

Location: Nixa HS, 514 S. Nicholas, Nixa

PLEASE NOTE: THERE ARE SLIGHT DIFFERENCES IN THE FLOW OF THE CONTEST FOR GUARD AND PERCUSSION. PLEASE READ ALL INFORMATION CAREFULLY.

Unit Check-In: Units will check in at the main entrance on the west side of the building. The doors are located under the "Nixa High School" sign and awning. Unit members, one director (with badge) and 7 additional people will be admitted. Additional staff/crew **MUST** purchase tickets. Your group can check in anytime after 10:30. **Please don't plan on arriving before 10:30.** (Please take note of equipment check in described below). Make sure your spiel sheets have been submitted and if not, you will need to complete one at check in. **UNIT MEMBERS AND STAFF MUST CHECK IN TOGETHER.** An escort will be provided for your assistance. If you would like to take advantage of this service please make sure that someone is available to meet your escort at the designated area at the designated time.

Dressing Facilities: Available on site. Again, remind students to be responsible and to take care of their personal items. MCCGA and Nixa Schools will not be responsible for lost or stolen items.

Storage: All units will have an area assigned to them for personal storage. You can bring equipment into the building at the designated time (see schedule) and then all equipment must be removed following your units performance. Refolding of tarps can be done in the grassy area outside of the building. If weather is an issue, guards will use the band room for this purpose and percussion will use a portion of the aux. gym.

PERCUSSION: We will have you unload your equipment straight into your warm up area. This will mean that you will not have any inside storage for large equipment but it will save you time moving the large amount of equipment that comes with your art. Obviously if it is raining or too cold, we will provide inside storage and take you the long way through the school.

PLEASE NOTE: Per school policy, no outside food or drink is to be brought into the building and Nixa HS is a smoke free CAMPUS (not just building).

Footwear and Equipment Protection: All equipment tips on rifles, poles, and sabres must be padded and taped. Any questionable equipment will not be allowed on the performance floor. **THIS WILL BE STRICTLY ENFORCED!** Hard soled shoes will need to be taped before your performance. All stands need to have the proper footing or be taped. Cart wheels must be in "indoor" condition.

Parking and Unloading of Performers and Equipment: Students can be dropped off in the circle drive in front of the main entrance. Buses and equipment trucks should park in the rear parking lot near the football field (SE part of the school). Equipment trucks may move around to the front of the building at your equipment check in time. Please then move your vehicle to the designated parking area. Following your performance, your equipment vehicles can move down close to the building to load and then please move back to the designated parking area. **PLEASE** do NOT park buses or equipment vehicles in spectator parking. They take up too much space and also can easily get blocked in to where you can't get out when needed.

Tabulating and Judging Area: These areas are off limits to everyone except authorized personnel. You can pick up your judges sheets and comments at the air gram table approximately 30 minutes following your performance.

Floor Size: There is ample room on both ends of the performance area as well as in the back. The doors entering and exiting the performance floor are double doors with no middle bar. **PLEASE NOTE: Guards** will enter from the performers back left and exit to the performers back right. **Percussion** will enter from the performers back right and exit to the performers back left.

Timing and Time Line: Please have plenty of help to move your equipment, especially percussion. We will be using a vertical timing line.

Music/MP3/Flash Drive: A CD player along with a variable speed tape deck will be provided for your performance. Bring music to the sound table prior to your performance. Sound testing can take place during breaks. **It is the director's responsibility to get your music and MP3/flash drive (for judges comments) to the sound table.** Please have a tape back up in case there are any problems with the player reading your CD. I also suggest having your music on a MP3 player as a back up. (Please only use tape or MP3 players as a back

up, not your primary sound source). If you use an MP3 player as your sound a member of your staff will be required to actually run the device.

Warm-Up Area: A sound system will not be available in the warm up area so you should plan on bringing your own. Percussion units are assigned to warm up in either the auxiliary gym or the band room. Guards will have warm-up in the auxiliary gym and will have the entire warm up time in one area. You should only use your music during the last half of your warm time and always be considerate of the volume. You should stage yourself so the music is not facing the other unit in the gym. Please note that your warm up time includes set up and tear down. You need to be clear of the room by your "move" time.

Percussion: If you come early to practice outside, please only do so 1 hour prior to your warm up time due to the school being located in a residential area. And please be considerate of not taking up parking with your equipment for rehearsal.

Score Sheets and Tapes: All units may pick up their judges sheets and tapes outside the marked off tabulation area.

Critique: Will be held in the hallway outside of the tabulating area. There will be a room available. You will sign up for critique at your unit check in.

Spectator Admission: \$7 per person, \$5 for students (with school ID) and seniors, and children 5 and under are no charge.

Contacts:

Craig Finger, Director of Bands (417) 597-3516

Pat Jacobs, Asst. Director (417) 619-4012

Kim Martin, Asst. Director (417) 299-5794

Jennifer Tomb, Guard Director (417) 459-2343

Percussion Flow

514 Nicholas Road

Unit Check In

Spectator Entrance/
ticket sales

Spectator parking

Spectator parking

Spectator Gym
Entrance

Audience

Performance
Area (vertical
time line)

Warm
Up
(band
rm)

Warm Up (gym)

Equipment Entrance
(band room)

Equipment
Entrance (Gym)

Equipment/Bus
Parking (@ FB field)

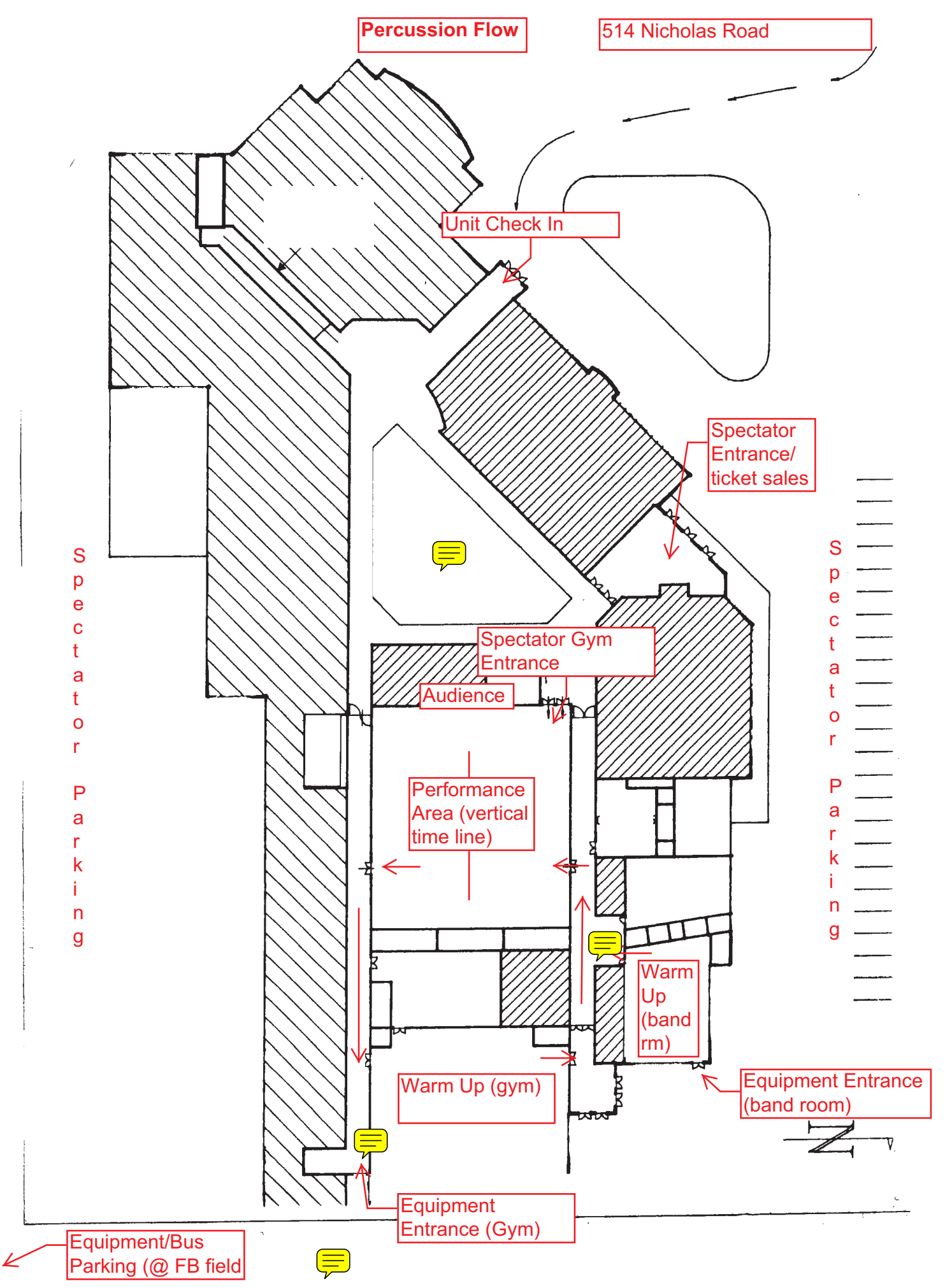

Guard Flow

514 Nicholas Road

Prop/Tarp Entrance
(1 hr prior)

Prop/Tarp Holding

Unit Check In

Spectator Entrance/
ticket sales

Report A

Spectator Gym Entrance

Audience

Performance Area (vertical
time line)

Report B

Tarp Folding if
weather requires

Warm Up "A"

Warm Up "B"

S
p
e
c
t
a
t
o
r

P
a
r
k
i
n
g

S
p
e
c
t
a
t
o
r

P
a
r
k
i
n
g

Equipment/Bus
Parking (@ FB field)

